



# Custom Damper Hub Application

Technical Assistance  
(410)298-4343

Quantity Needed

Price break requires ten part order

Date \_\_\_\_\_

Rush Order (circle one)

Y / N

## Engine Information

Fax the completed form to us at 410-298-3579

Engine \_\_\_\_\_

HP \_\_\_\_\_

Time between rebuilds \_\_\_\_\_

Displacement \_\_\_\_\_

Max RPM \_\_\_\_\_

## Crankshaft Information

OEM Make \_\_\_\_\_

Aftermarket Make \_\_\_\_\_

Weight \_\_\_\_\_

Crank snout diameter \_\_\_\_\_

For best results measure your crankshaft snout diameter at three points to .0000" \_\_\_\_\_

Degrees from TDC to first keyway

CW

CCW

Keyway #1

3/16"

1/4"

If you have a second keyway how many degrees from the first is it?

90°

180°

270°

Keyway #2

3/16"

1/4"

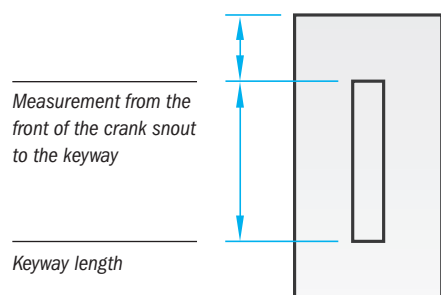

## Hub Information

Steel

Aluminum

### Bolt Pattern

Chevrolet 3 x 3.200"

Ford 3 x 3.300"

Ford 4 x 3.300"

Chrysler OEM 6 x 2.810" (5/16 bolts) with offset hole

Standard Chrysler blower application bolt circle with 6 x 2.810" (3/8 bolts)

Standard Chevrolet blower application bolt circle with 6 x 3.200" (3/8 bolts)

Other \_\_\_\_\_

### Hub Length

Overall Hub Length \_\_\_\_\_

Back of Hub to front of first pulley if required \_\_\_\_\_

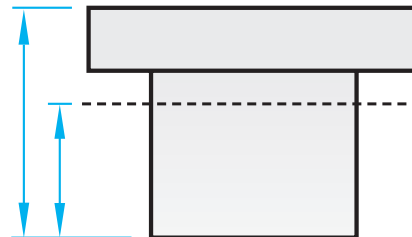

### Hub Depth

Measurement from front of crank snout to desired back of damper hub \_\_\_\_\_

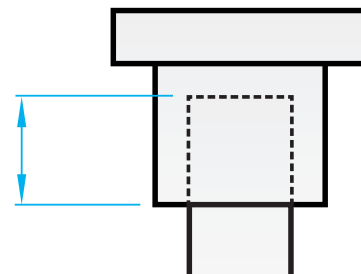

## Accessory Drives

Please provide information on all necessary drives located behind the damper. For HTD or Gilmer indicate if belt guide is required.

V-belts Y / N

x 1

x 2

HTD Y / N

\_\_\_\_\_ # Teeth

belt guide

Other \_\_\_\_\_

Serpentine Grooves Y / N

4 groove

6 groove

8 groove

Gilmer Y / N

belt guide

# Customer Information

Account # \_\_\_\_\_

Name \_\_\_\_\_

Company \_\_\_\_\_

Phone \_\_\_\_\_ Fax \_\_\_\_\_

E-mail \_\_\_\_\_

Additional phone numbers \_\_\_\_\_

\_\_\_\_\_

## Billing Address

Address \_\_\_\_\_

City \_\_\_\_\_ State \_\_\_\_\_ Zip \_\_\_\_\_

## Shipping Address *(if different from billing address)*

Address \_\_\_\_\_

City \_\_\_\_\_ State \_\_\_\_\_ Zip \_\_\_\_\_

### Price Information

All custom hubs and dampers require a \$250 engineering fee to start.

Hub - Plated, No Accessory drives .....	\$350
Hub - Plated, V-belt or Serpentine grooves.....	\$400
Hub - Plated, HTD or Gilmer - no guide .....	\$450
Hub - Plated, HTD or Gilmer - w/ guides .....	\$475

### Terms and Conditions

Before beginning any custom work, ATI requires the customer to pay a deposit of 50% of the total price, which is non-refundable. Once the customer has approved the final drawing of the hub, and ATI has built the hub to those specifications, there will be no refunds given unless it is clear that ATI was responsible for an error in manufacturing the hub. If it is determined that the drawing contained an error, but the customer approved the final drawing, there will be no refund given. If there are no errors on the drawing, but the hub is not within the specs on the drawing, then it will be the responsibility of ATI to remake the hub as quickly as possible, and to pay the charges for shipping the remade hub to the customer via overnight shipping if needed.

Once the customer signs off on the final drawing, 3 to 4 weeks are required to manufacture the hub. It will then be shipped out complete, plated and ready to install.

If a customer wants a custom hub built in a shorter period of time, ATI can provide a "rush" order for an additional 50% of the purchase price. The hub can be ready in as little as 2 weeks, depending on the work required and your availability to okay engineering work and drawings.

I agree to the listed terms above

Signature \_\_\_\_\_ Date \_\_\_\_\_

Print Name \_\_\_\_\_

### Rush Orders

Take bare price and add 50%.  
Ex. \$200 regular price for rush is \$300

### Rush Orders

1. If we begin a rush job, and are unable to contact the customer for information regarding the hub for more than 24 hours, then the rush status will be dropped. If the order is cancelled due to losing rush status, the deposit will be forfeited.

2. If rush status is dropped, the hub can be processed at normal lead times if the customer agrees. The deposit will be kept on file and the customer will be charged the price difference at the normal production rate.

3. In the event that ATI is unable to complete the hub within a rush time frame, and the customer wants to no cancel the order, the rush deposit will be returned.

NOTE: Hubs on "rush" cannot be plated. The plating process takes one week from the time the hub leaves ATI until it returns ready to ship. Hubs can be returned at a later time for plating and the charge is \$25 + S/H.

ATI uses standard ground shipping for all products. If another mode of shipping is desired, the customer will be responsible for the charge, unless otherwise noted.

### INTERNAL USE ONLY

Date Received \_\_\_\_\_

Approved by \_\_\_\_\_

Info and \$ correct \_\_\_\_\_